

High There Instructions

SKU 3518



Looking to get buzzed? With 10 speeds and an easy to use one touch button, this compact mini bullet will keep you tapped into a higher vibration! Use it solo or with your favorite bedroom bud! Sensually soft and coated in velvety silicone, High There can be used in a harness or Ruby Ring! With a fun pot leaf appliqué, you could keep it for your own stash or gift it to your favorite stoner! It's lightweight and portable so you can use it here, there, or anywhere! This vibe is so dope, it can be used in the tub or shower!

Features :

- 1 year warranty
- Waterproof and submersible
- Made Silky smooth medical grade silicone
- Not for use with silicone lubricants
- Phthalate free
- Length: 3 inches
- Width: .08 inch
- Rechargeable: USB charge cord included
- Charge time: 1.5 hours
- Run time low speed: 2 hours
- Run time high speed: 1.5 hours

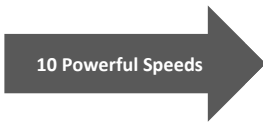

Operating

ON/OFF: Press and hold for 3 seconds to start and initiate the 1st speed, press and hold for 3 seconds to stop. The button will glow when On. Tap the button to adjust speed and tempo of the toy.

Vibration and Pulsation: Tap the On/Off for the 9 additional settings of vibration. Each tap will cycle to the next vibration level of intensity.



Cleaning and storage:

Clean before and after use. Dry completely. For best results we recommend using Athena's (antibacterial) Mighty Tidy Toy Cleaner (SKU MTT-1235 4 oz. or SKU MTT-2762 8 oz.)

Lubrication:

Be sure to use ample lubrication with your bedroom toys. For great results try Athena's Perfectly Pure Intimate Moisturizer SKU 5701. You can find additional lubrication options on our web site or in our catalog.

Follow these simple steps to help extend the life cycle of your items

Do not store products near extreme cold or heat.

Do not store your adult toys in a manner where they are touching. Keep them separated to avoid melting or discoloring.

Do not place lotion bottles or adult novelties directly on furniture surfaces. Place them on a cloth to protect your toys and the finish on your furniture.

Caution :

For adult use as a non-medical pleasure device only. Discontinue use in the event of any medical condition or pain.

Warranty:

All sales are final due to the intimate nature of our products. No cash refunds will be given. Effective February 1, 2021, this motorized product is guaranteed for 1 year for a replacement of the exact item. If you purchased this item at a party and need a replacement, please contact your Goddess or Adonis directly. If you purchased this product on the Athena's website and need a replacement, call (877)-ATHENAS or email our Customer Care Liaison at customerservice@athenashn.com for instructions to send back your item.

All defective product returns must be accompanied by a pre-authorization number. If product arrives broken or breaks within 30 days, it's the client's responsibility to pay for the shipping of the broken item to Athena's, Athena's is responsible for the shipping of the replacement. If this item breaks after 30 days of receipt, it's the client's responsibility to pay for the shipping of the broken item to Athena's and the shipping for the replacement item.



©March 2022
Athena's Home Novelties, Inc.
Woonsocket RI 02895
www.athenashn.com
1-877-ATHENAS

Charging

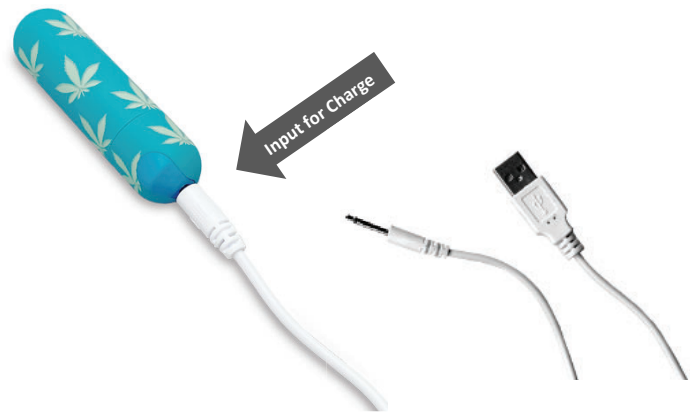

This toy comes partially charged. Fully charge prior to first use. Connect the USB cable to the USB port of your computer or other power source and connect to the other end to the toys charging port at the base of the bullet.

The LED light will blink when charging and become solid when fully charged. Unplug both ends of the charging cord when the light remains on (solid) and fully charged. We recommend you do not to charge for long, extended periods of time.

We recommend fully charging your product once every 6 months. Only use the cord supplied with this product or an Athena's authorized replacement cord.

Charge time: 1.5 hours, Run time low speed: 2 hours, Run time high speed: 1.5 hours