

WelComing Operating Instructions



SKU 3431



Welcome historic levels of orgasmic bliss into your life with this satin smooth new age sex toy! It's easy to hold and use. Touchless Airwave Technology and a whisper quiet motor creates an earth shattering dual experience. The technology works by gently and indirectly, stimulating the clitoris with 10 different intensity levels ranging from super-soft to powerful along with a G-spot extension will raise in intensity as you increase the air wave levels. WelComing encircles the clitoris and stimulates it with 4,500 RPM of soft pressure air waves, producing waves of orgasms. Submersible and waterproof you'll be WelComing pleasure in the shower or bubble bath! The hygienically sealed membrane protects the toy's mechanism. USB magnetic charge cord included.

Features :

- USB magnetic charge cord included
- Phthalate free
- Colors will vary
- Medical grade silicone with ABS plastic trim
- Not for use with silicone lubricants
- Provides G-spot stimulation
- Waterproof

Length: 5.60 inches
Insertable length: 3.5 inches
Width: 2.36 inches at widest point

Complete charge: 2 hours
Run time: 1 hour

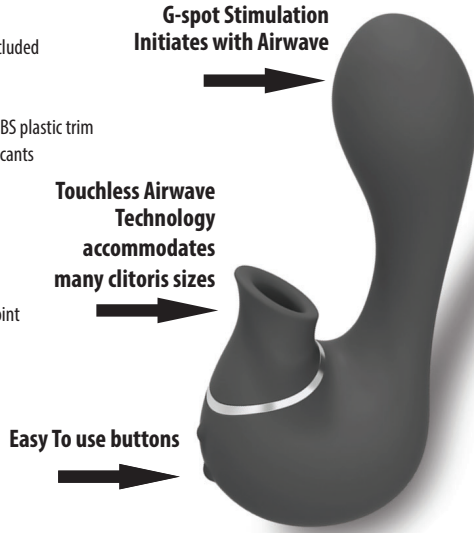

Operating



Airwave On/Off
Press and hold for 6 seconds
Tap to cycle up intense frequencies

Vibration On/Off
Press and hold for 6 seconds
Tap to cycle up intense frequencies

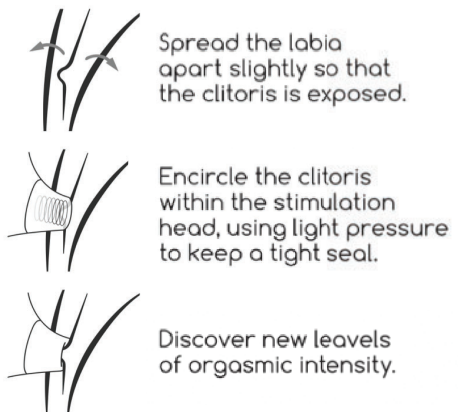

Spread the labia apart slightly so that the clitoris is exposed.

Encircle the clitoris within the stimulation head, using light pressure to keep a tight seal.

Discover new levels of orgasmic intensity.

Cleaning and storage

Clean before and after use. Dry completely. For best results we recommend using Athena's (antibacterial) Mighty Tidy Toy Cleaner (SKU MTT-1235 4 oz. or SKU MTT-2762 8 oz.)
Store in a cool dry location.

Lubrication

Be sure to use ample lubrication with your bedroom toys. For great results try Athena's Perfectly Pure Intimate Moisturizer (SKU 5701). You can find additional lubrication options on our web site or in our catalog. Do not use this vibe with silicone lubricants.

Follow these simple steps to help extend the life cycle of your items

- Do not store products near extreme cold or heat.
- Do not store your adult toys in a manner where they are touching. Keep them separated to avoid melting or discoloring.
- Do not place lotion bottles or adult novelties directly on furniture surfaces. Place them on a cloth to protect your toys and the finish on your furniture.

Caution: For adult use as a non-medical pleasure device only. Discontinue use in the event of any medical condition or pain.

Warranty

All sales are final due to the intimate nature of our products. No cash refunds will be given.
Effective February 1, 2021, this motorized product is guaranteed for 1 year for a replacement of the exact item. If you purchased this item at a party and need a replacement, please contact your Goddess or Adonis directly. If you purchased this product on the Athena's website and need a replacement, call (877)-ATHENAS or email our Customer Care Liaison at customerservice@athenashn.com for instructions to send back your item. All defective product returns must be accompanied by a pre-authorization number.

If product arrives broken or breaks within 30 days, it's the client's responsibility to pay for the shipping of the broken item to Athena's, Athena's is responsible for the shipping of the replacement. If this item breaks after 30 days of receipt, it's the client's responsibility to pay for the shipping of the broken item to Athena's and the shipping for the replacement item.



©June 2021
Athena's Home Novelties, Inc.
640 Winter Street, Woonsocket RI 02895
www.athenashn.com
1-877-ATHENAS

Charging

Charging

Connect the USB cable to the USB port of your computer or other power source and snap the magnetic charge port into place at the base of the toy.

The LED light will blink when charging and become solid when fully charged. There is no danger of battery damage by overcharging, but we recommend to not over charge for long periods of time.

Rechargeable: USB magnetic charge cord included

Complete charge: 2 hours

Run: 1 hour

