

On The Flip Side Operating Instructions



ATHENA'S
HOME NOVELTIES

SKU 3429

The sensually contoured palm sized massager allows you to explore pleasure on all sides! The underside has a raised, bullseye textured pleasure bump to hit the spot! Flip it over for a silky smooth spine that can stroke any erogenous zone. The rounded tip can be used for pinpoint tantalization. Flip it on its side for yet another sensational sensation! 10 indulgent vibrations, pulsations and escalations and a silky, silicone surface make for flippin' fantastic foreplay! Small enough to slip into your purse or panties for knee-shaking pleasure wherever you go.

Features :

- USB Rechargeable (cord included)
- Self-sealing charging port
- Pure silicone with ABS Plastic metallic detail
- Not for use with silicone lubricants
- Waterproof
- Security travel lock (automatic)
- Phthalate free
- Whisper quiet
- Memory chip resumes on last function used
- Security travel lock

Length: 4.5 inches

Width: 2.75 inches

Charge time: 120 minutes

Run time high speeds: 90 minutes

Run time low speeds: 120 minutes



Flip Side

Top Side

Operating

ON/OFF/Vibrate: Press the power button for 3 seconds to disengage the security lock, turn ON and initiate the first speed. Press for 3 seconds for OFF and to engage the security lock. The button will glow when ON. Memory Chip will resume last function used.

Vibration and Pulsation: Tap the top button to adjust speed and cycle through the other 9 functions.

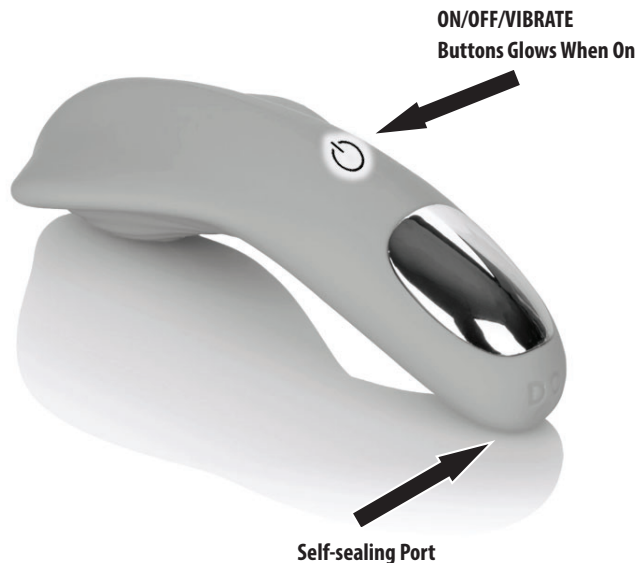

Cleaning and storage

Clean before and after use. Dry completely. For best results we recommend using Athena's (antibacterial) Mighty Tidy Toy Cleaner (SKU MTT-1235 4 oz. or SKU MTT-2762 8 oz.)

Store in a cool dry location.

Lubrication

Be sure to use ample lubrication with your bedroom toys. For great results try Athena's Perfectly Pure Intimate Moisturizer (SKU 5701). You can find additional lubrication options on our web site or in our catalog. Do not use this vibe with silicone lubricants.

Follow these simple steps to help extend the life cycle of your items

Do not store products near extreme cold or heat.

Do not store your adult toys in a manner where they are touching.

Keep them separated to avoid melting or discoloring.

Do not place lotion bottles or adult novelties directly on furniture surfaces.

Place them on a cloth to protect your toys and the finish on your furniture.

Warranty

All sales are final due to the intimate nature of our products. No cash refunds will be given.

Effective February 1, 2021, this motorized product is guaranteed for 1 year for a replacement of the exact item. If you purchased this item at a party and need a replacement, please contact your Goddess or Adonis directly. If you purchased this product on the Athena's website and need a replacement, call (877)-ATHENAS or email our Customer Care Liaison at customerservice@athenashn.com for instructions to send back your item. All defective product returns must be accompanied by a pre-authorization number.

If product arrives broken or breaks within 30 days, it's the client's responsibility to pay for the shipping of the broken item to Athena's, Athena's is responsible for the shipping of the replacement. If this item breaks after 30 days of receipt, it's the client's responsibility to pay for the shipping of the broken item to Athena's and the shipping for the replacement item.



ATHENA'S
HOME NOVELTIES

www.athenashn.com

©June 2021 Athena's Home Novelties, Inc.
Woonsocket, RI 02895 1-877-ATHENAS

Charging

Charging

Charge fully prior to first use. Connect the USB cable to the USB port of your computer or other power source and connect the other end to the toys charging port.

LED light will flash while charging and glow solid when fully charged. Battery life depends on frequency and speed of use. We recommend fully charging your product once every 6 months.

Self-sealing charging port for waterproof play integrity.

Rechargeable: USB charge cord included

Complete charge: 2 hours

Run time high speed: 1.5 hours

Run time low speed: 2 hours

Input for Charge

